

12,000 SQ. FT. SEPTIC AREA

12,000 SQ. FT. SEPTIC AREA

12,000 SQ. FT. SEPTIC AREA

LOT 118 SIDEWALK EXHIBIT 01-25-07  
Scale: 1" = 30'

WALK SHALL BE GRADED IN RELATION TO TOP OF CURB GRADE AS SHOWN EXCEPT AT WEST END WHERE WALK SHALL BE GRADED AS NOTED

WALK SHALL PITCH 1" TOWARDS CURB EXCEPT FOR WEST END OF LOT WHERE SIDEWALK NEEDS TO TRANSITION FOR REVERSE PITCH DUE TO 100-YEAR OVERFLOW ROUTE

BACK OF WALK IS 12.5' FROM BACK OF CURB

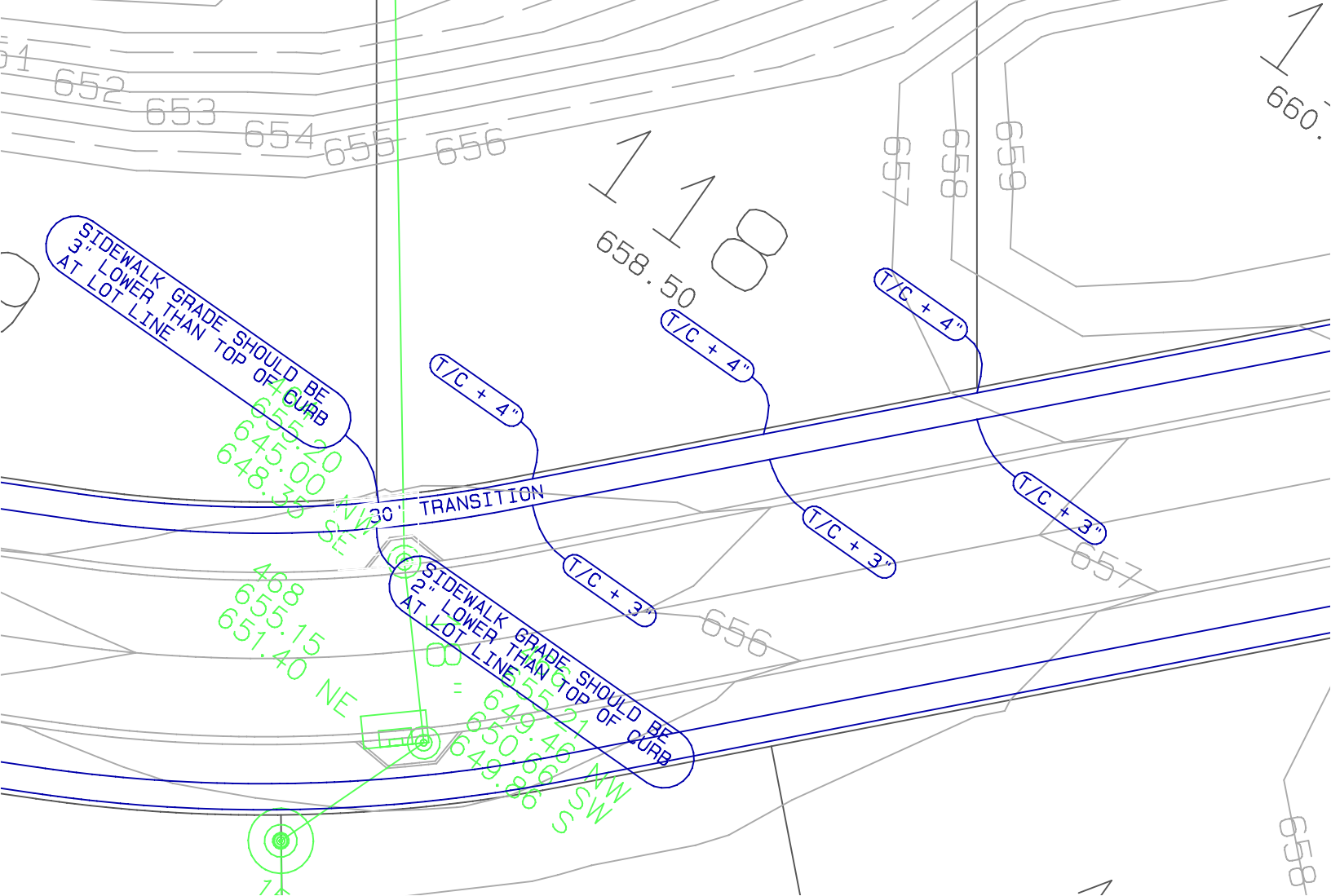

SIDEWALK GRADE SHOULD BE 3" LOWER THAN TOP OF CURB AT LOT LINE

SIDEWALK GRADE SHOULD BE 2" LOWER THAN TOP OF CURB AT LOT LINE

655.20  
645.00  
648.38

468  
655.15  
651.40

649.55  
650.46  
649.86

T/C + 4"

T/C + 3"

T/C + 4"

T/C + 4"

T/C + 3"

T/C + 3"

118  
658.50

657  
658  
659

660

658