

# PLAT OF SURVEY

LOT 147 OF WHITETAIL RIDGE SUBDIVISION  
 ACCORDING TO THE PLAT THEREOF RECORDED JUNE 8, 2005 AS DOCUMENT NUMBER  
 200500015985, BEING A SUBDIVISION OF PART OF SECTION 12-36-7, PART OF SECTION 7-36-8,  
 AND PART OF THE FORMER WAISH-KEE-SHAW RESERVATION,  
 IN KENDALL & NA-AU-SAY TOWNSHIPS, KENDALL COUNTY, ILLINOIS

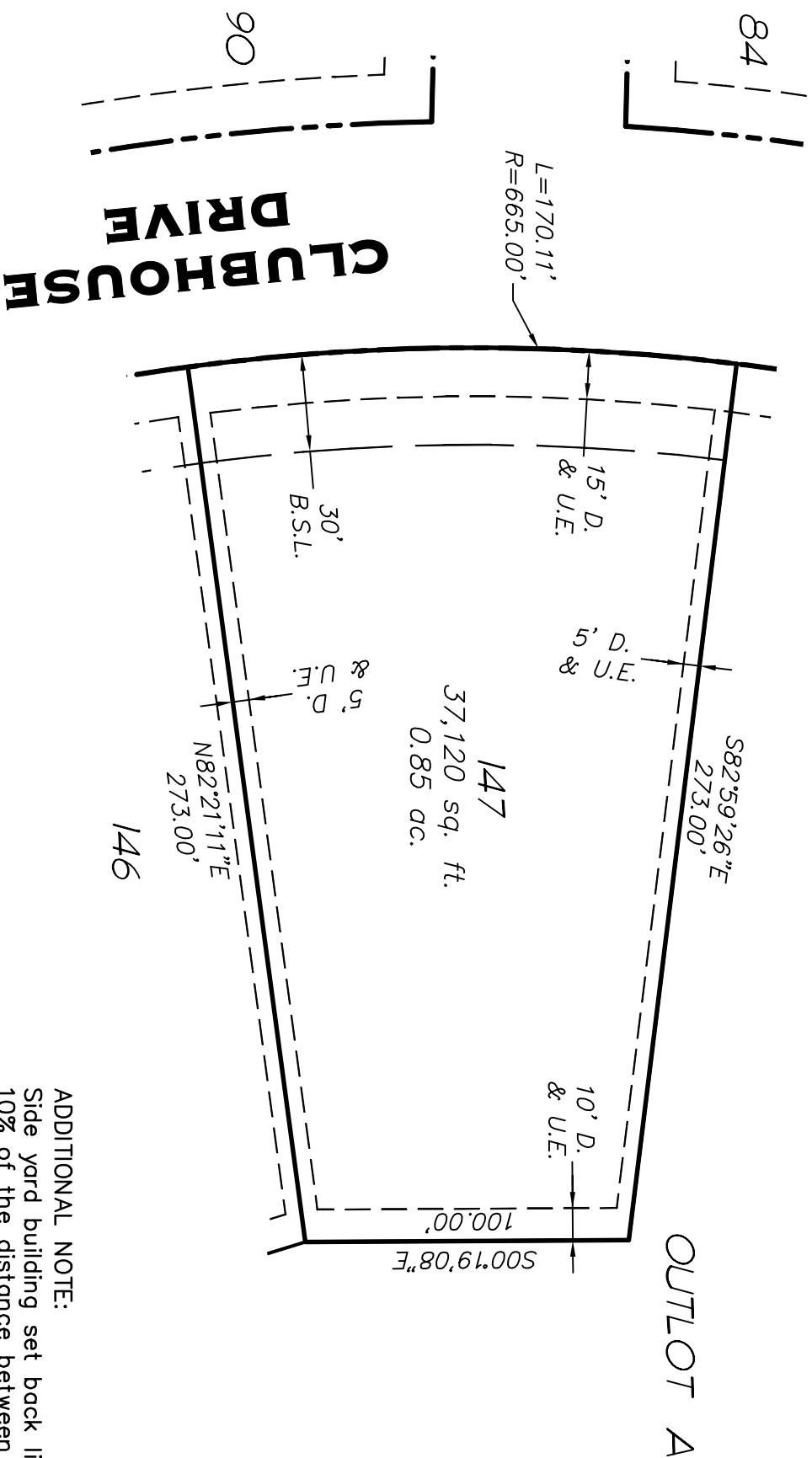

STATE OF ILLINOIS )  
 ) S.S  
 COUNTY OF KENDALL )

This is to certify that we have surveyed the premises above described,  
 and that the plat hereon is a representation of the said survey.

Dated at Yorkville, Kendall County, Illinois July 19, A.D. 2005.  
 Smith Engineering Consultants, Inc.

Illinois Professional Land Surveyor No. 3359  
 License Expiration 11/30/06

**ADDITIONAL NOTE:**  
 Side yard building set back lines are 10' or 10% of the distance between side lot lines at the building setback line, as determined by the Kendall County Planning, Building and Zoning Department, whichever is greater.

**NOTE:** Only those Building Line Restrictions or Easements shown on a Recorded Subdivision Plat are shown hereon unless the description ordered to be surveyed contains a proper description of the required building lines or easements.  
 \* Basis of bearings: Geodetic North [Recorded Whittail Ridge Plat of Subdivision]  
 \* No distance should be assumed by scaling.  
 \* No underground improvements have been located unless shown and noted.  
 \* No representation as to ownership, use, or possession should be hereon implied.  
 \* This Survey and Plat of Survey are void without original embossed or red colored seal and signature affixed.  
 \* Field work completed: Under construction at time of survey.  
 \* This professional service conforms to the current Illinois minimum standards for a boundary survey and was performed for:

**Whittail LLC**

Compare your description and site markings with this plat and AT ONCE report any discrepancies which you may find.

**SMITH ENGINEERING CONSULTANTS, INC.**  
 CIVIL/STRUCTURAL ENGINEERS AND SURVEYORS  
 704 JOHN STREET  
 YORKVILLE, ILLINOIS 62458  
 PHONE: 618-292-2000 FAX: 618-292-7044  
 www.smithengineering.com  
 \* MEMBER ILLINOIS PROFESSIONAL DESIGN FIRM # 184-000108

COMP. FILE: 040039-101-147.dwg  
 PLOT FILE: S140A.DWG  
 PLOT: 10/24/11



D.E. = PUBLIC DRAINAGE EASEMENT  
 L.E. = LANDSCAPE EASEMENT  
 M.E. = MAINTENANCE AND CONSTRUCTION EASEMENT  
 S.E. = SIDEWALK EASEMENT  
 U.E. = PUBLIC UTILITY EASEMENT  
 B.S.L. = BUILDING SETBACK LINE

**NOTE:**  
 5/8" STEEL REBAR TO BE SET AT ALL LOT CORNERS UNLESS OTHERWISE NOTED PER RECORDED PLAT OF SUBDIVISION.

LOT 147 OF WHITETAIL RIDGE  
 SUBDIVISION, KENDALL COUNTY,  
 ILLINOIS

NO.	REVISIONS	DRAWN BY	DATE	PROJECT NO.
1		NTD	7/19/05	040039_09
2		DESIGNED BY	HORIZ. SCALE	SHEET NO.
3		CHECKED BY	VERT. SCALE	1
4		CD	N/A	